

FOR SUBLEASE

1360 Walnut Street, Boulder

CONTEMPORARY OFFICE SPACE



1360 WALNUT STREET, BOULDER, COLORADO

- 1360 Walnut Street offers a beautiful, contemporary “Plug & Play” opportunity located in downtown Boulder, Colorado in one of Boulder’s newest and most contemporary buildings at One Boulder Plaza.
- Central location with up to 11 parking spaces on-site.
- Suite 102 offers a mix of executive offices and open areas, two large conference rooms, a custom kitchen/break area and potentially – all furniture and phone systems.
- 7,743 Square Feet available immediately
- Sublease Term: Immediate - March 31, 2012
- Sublease Rate: \$21.00 per square foot



EXCLUSIVELY
REPRESENTED BY

Ronan B. Truesdale

303.447.2700

Russell A. Lee

1919 Fourteenth Street, Suite 800 | Boulder, CO 80302
303.447.2700 | www.keys-commercial.com

Keys Commercial

FOR SUBLEASE

PERFECT DOWNTOWN LOCATION

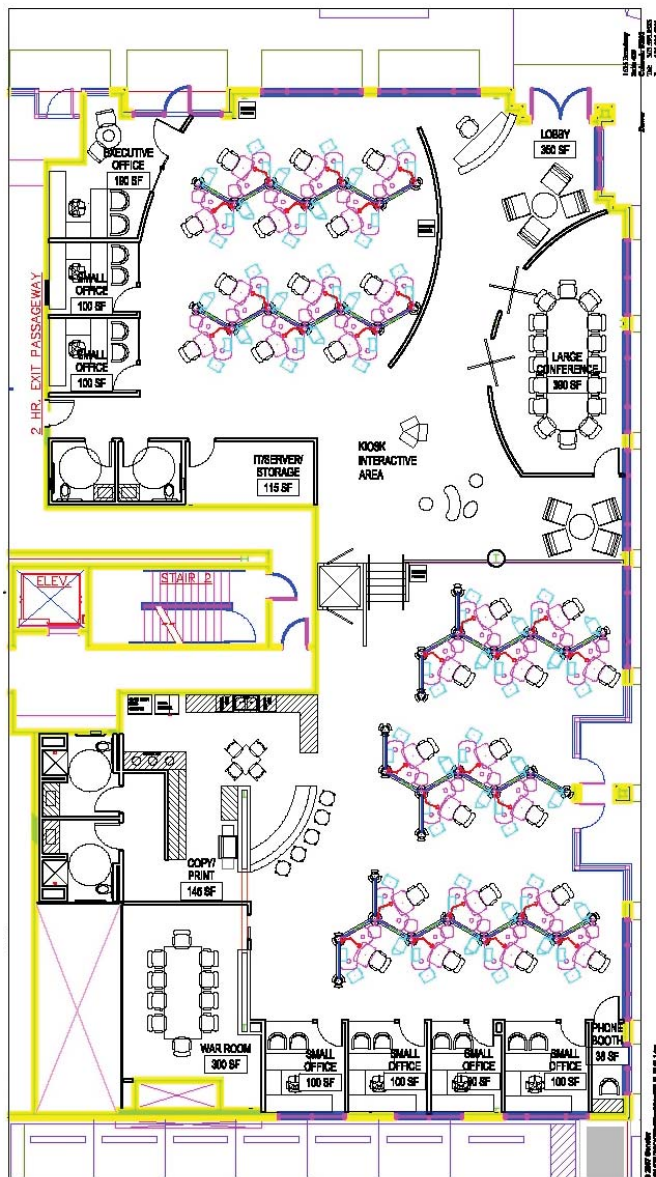

EXCLUSIVELY
REPRESENTED BY

Ronan B. Truesdale
Russell A. Lee

303.447.2700

1919 Fourteenth Street, Suite 800 | Boulder, CO 80302
303.447.2700 | www.keys-commercial.com

Keys Commercial

Keys Commercial obtained the information above from sources we believe to be reliable. However, we have not verified its accuracy and make no guarantee, warranty or representation about it. It is submitted subject to the possibility of errors, omissions, change of price, rental or other conditions, prior sale, lease or financing, or withdrawal without notice. You and your tax and legal advisors should conduct your own investigation of the property and transaction. All marks displayed on this document are the property of their respective owners.